

ARD 250 Immersion Fitting

Fitting for safe and easy process integration of sensors with PG 13.5 thread.



The fitting is suitable for tanks, basins and channels. It enables the safe installation of sensors for measuring process variables such as pH value, conductivity or oxygen content. The special design facilitates sensor replacement.

Applications

Water, wastewater, industrial water

Facts and Features

- Safe functioning, easiest maintenance thanks to a special and unique design
- Easy removal/installation of the sensor adapter with just ½ turn of a coupling nut (manual).
- Removal of the sensor adapter through the immersion tube or from the bottom
- No cable twisting during sensor installation
- Sensor adapter: PG 13.5
- Immersion depths: 100 / 200 cm
- Material: PP-H
- Process connections:
 - DN 50 flange with sliding flange bushing
 - Wall holder
 - Catenary suspension
- Cable glands: EPDM cap with cable support sleeves

Catenary suspension

Ambient side with rubber cap



Plastic tube with special sleeve geometry
1000 or 2000 mm

Sensor adapter

ARD 250 Immersion Fitting

Specifications

Sensors	Ø 12 mm, length 120 mm	
Diameter	50 mm	
Pressure/Temperature	Unpressurized processes, max. 0.3 bar static pressure / 0 ... 90 °C	
Process connections	Loose flange EN 1092-1	DN50, adjustable position, unpressurizable, sealed
	Wall holder	Pipe clips PP
	Catenary suspension	
Wetted materials	Fitting	PP-H
	Sealing material	EPDM / FKM
	Catenary suspension	1.4571, Nylon
Sensor protection in the process	Probe guard integrated in the sensor adapter for sensors with 12 mm dia., 120 mm length, PG 13.5 thread	
Nominal body length	1000 / 2000 mm	
Transport and storage temperature	14 ... 158 °F (-10 ... 70 °C)	
Ambient temperature	23 ... 131 °F (-5 ... 55 °C)	
Protection according to EN 60529	Ambient side open	IP 10
	Ambient side with rubber cap	IP 65

Removing the Sensor Adapter for Replacing the Sensor

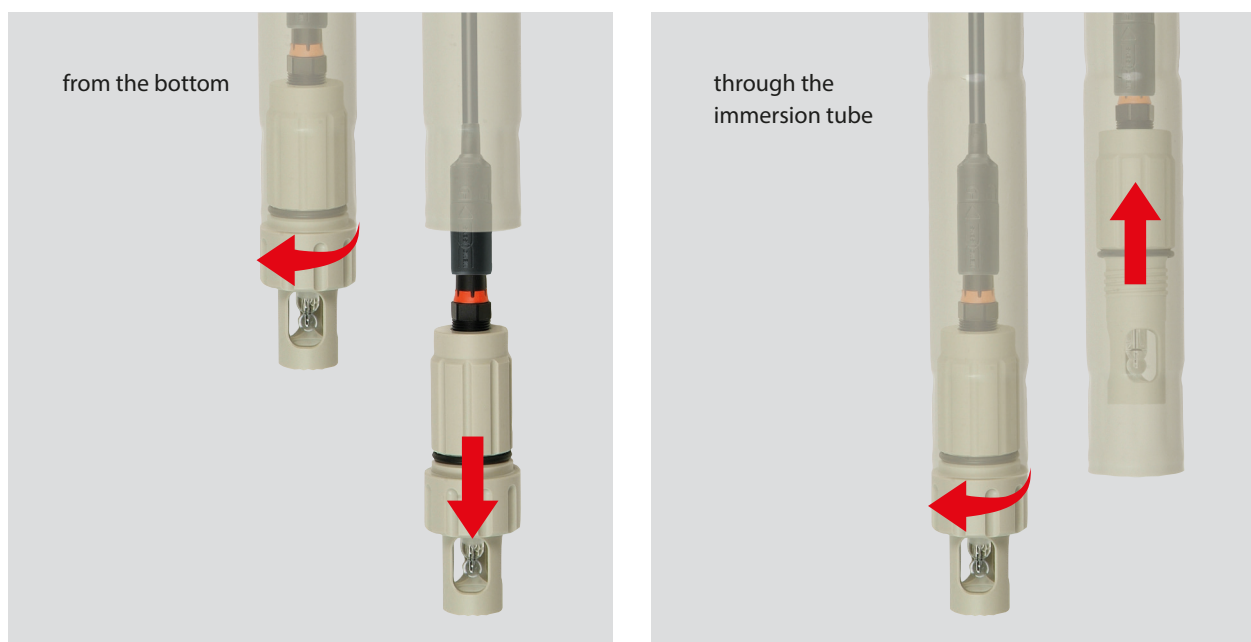

Product Range

Immersion fitting	ARD 250-							
Sensor adapter	1 x PG 13.5	1						
Gasket material	FKM	A						
	EPDM	B						
Process connection	Flange, loose, DN50 PN 10/16, sliding flange bushing, unpressurizable	A	B	1				
	Wall holder, pipe clips PP	W	R	0				
	Catenary suspension	S	0	0				
Ambient side	Open				A			
	Rubber cap with EPDM cable support sleeves				C			
Nominal body length [cm]	100					1	0	0
	200					2	0	0

ARD 250 Immersion Fitting

Dimension Drawings

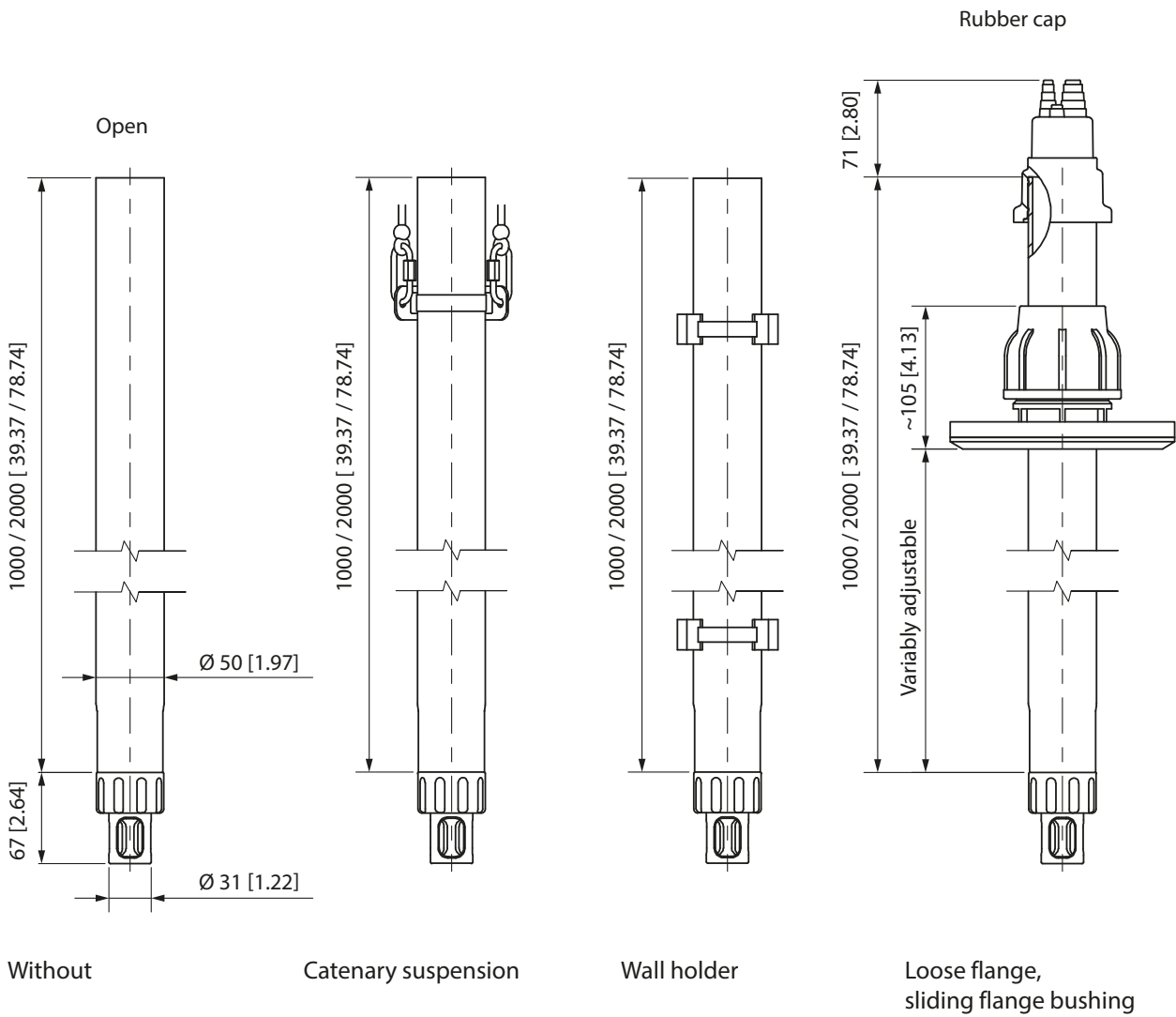

All dimensions in mm [inches].